

## -F Probe Installation (Throat Mounting)

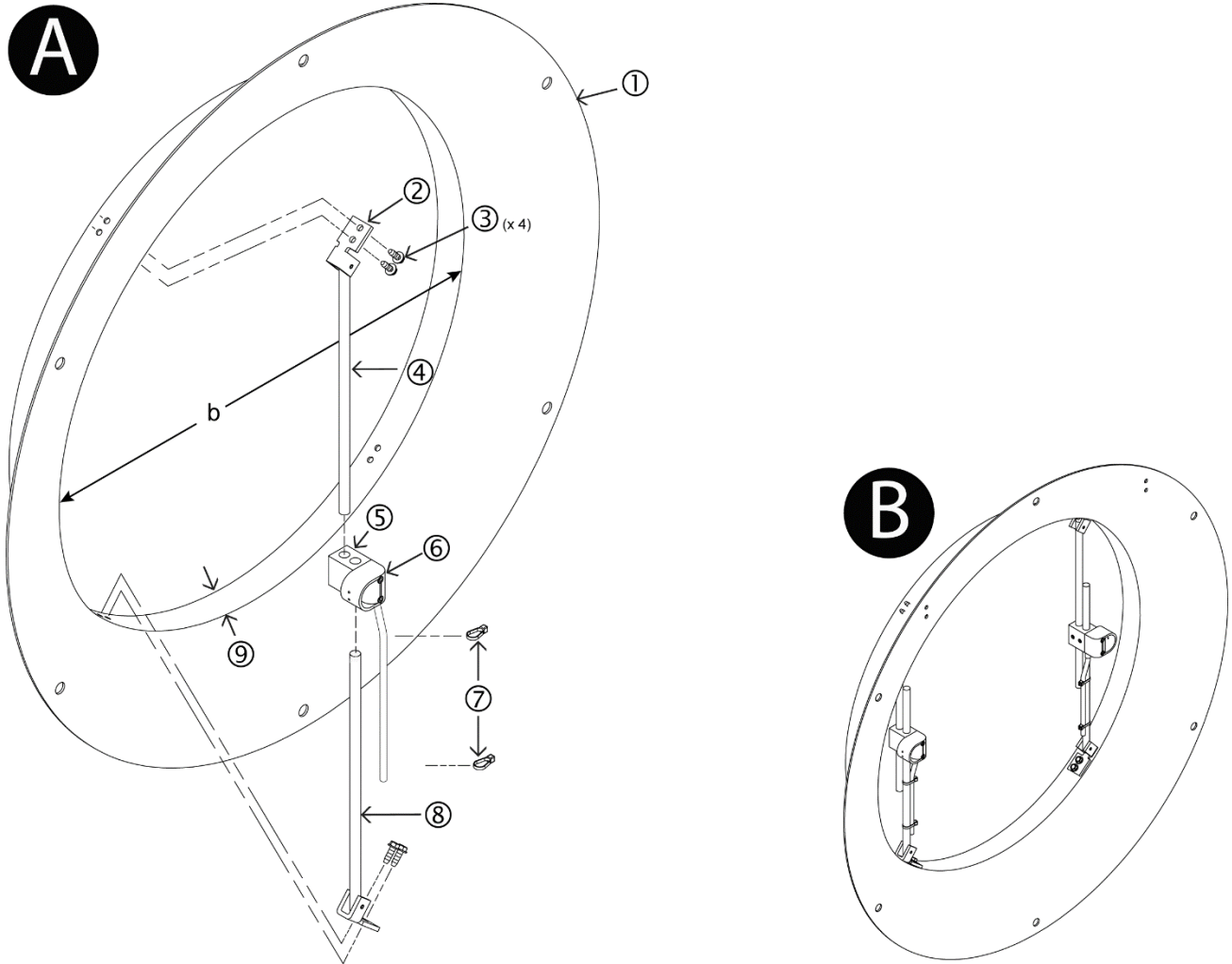

Step 1. Select a location on the fan that allows clearance for probe placement and installation.



*Single and dual inlet fan applications (-F/SI and -F/DI) use two probes per inlet, one each LEFT and RIGHT. Fan array models (-F/An) can use either one or two probes per inlet. If using one probe per inlet it is recommended to install probes alternating LEFT and RIGHT starting with LEFT in fan 1.*



*If installing two probes in fan inlet, probes should be installed parallel to each other.*



*It is recommended probes be installed vertically with sensors on horizontal centerline and cables exiting downward. Due to obstructions in the fan inlet it may be necessary to rotate the probes to complete installation.*

REFER TO FIGURE "A" WHEN COMPLETING STEPS 2 TO 13.



*When installing probes, the sensor housing shroud should always be pointing toward the side of the fan inlet bell indicated by the LEFT/RIGHT labels of the sensors. Figure "A" shows the LEFT side probe.*

Step 2. Measure the diameter 'b' across the centerline of the throat [9] at the smallest diameter of the fan inlet bell [1].

Step 3. Use the following table to determine “a” the distance between the roll pin [1] of each foot [2] and the set screws [2] on the sensor mounting block [5]:

**Table 1. Throat Mount Dimension ‘a’ Determination**

Inlet Diameter "b" (in)	"a" (in)	Inlet Diameter "b" (mm)	"a" (mm)
6	1-14/16	152.40	48.24
7	2-4/16	177.80	57.52
8	2-10/16	203.20	66.74
9	3	228.60	75.91
10	3-6/16	254.00	85.04
11	3-11/16	279.40	94.15
12	4-1/16	304.80	103.24
13	4-7/16	330.20	112.32
14	4-12/16	355.60	121.38
15	5-2/16	381.00	130.43
16	5-8/16	406.40	139.47
17	5-14/16	431.80	148.51
18	6-3/16	457.20	157.54
19	6-9/16	482.60	166.57
20	6-15/16	508.00	175.59
21	7-4/16	533.40	184.61
22	7-10/16	558.80	193.62
23	8	584.20	202.63
24	8-5/16	609.60	211.64
25	8-11/16	635.00	220.65

Inlet Diameter "b" (in)	"a" (in)	Inlet Diameter "b" (mm)	"a" (mm)
26	9-1/16	660.40	229.66
27	9-6/16	685.80	238.66
28	9-12/16	711.20	247.66
29	10-2/16	736.60	256.66
30	10-7/16	762.00	265.66
31	10-13/16	787.40	274.66
32	11-3/16	812.80	283.66
33	11-8/16	838.20	292.65
34	11-14/16	863.60	301.65
35	12-4/16	889.00	310.64
36	12-9/16	914.40	319.63
37	12-15/16	939.80	328.63
38	13-5/16	965.20	337.62
39	13-10/16	990.60	346.61
40	14	1016.00	355.60
41	14-6/16	1041.40	364.59
42	14-11/16	1066.80	373.58
43	15-1/16	1092.20	382.57
44	15-7/16	1117.60	391.56
45	15-12/16	1143.00	400.55

Inlet Diameter "b" (in)	"a" (in)	Inlet Diameter "b" (mm)	"a" (mm)
46	16-2/16	1168.40	409.54
47	16-8/16	1193.80	418.53
48	16-13/16	1219.20	427.51
49	17-3/16	1244.60	436.50
50	17-9/16	1270.00	445.49
51	17-14/16	1295.40	454.48
52	18-4/16	1320.80	463.46
53	18-10/16	1346.20	472.45
54	18-15/16	1371.60	481.43
55	19-5/16	1397.00	490.42
56	19-11/16	1422.40	499.41
57	20	1447.80	508.39
58	20-6/16	1473.20	517.38
59	20-12/16	1498.60	526.36
60	21-1/16	1524.00	535.35
61	21-7/16	1549.40	544.33
62	21-13/16	1574.80	553.32
63	22-2/16	1600.20	562.30
64	22-8/16	1625.60	571.29
65	22-14/16	1651.00	580.27
66	23-3/16	1676.40	589.26

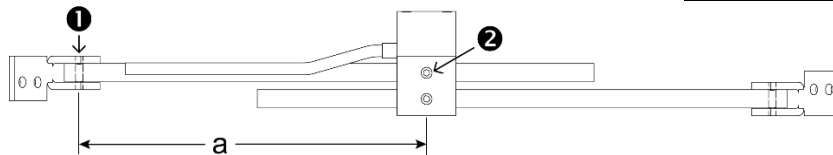

Step 4. Insert upper mounting rod [4] into the hole of the sensor mounting block [5] furthest from sensor housing [6].

**i** Both rods are identical to each other, and can be used in either the upper or lower location.

Step 5. Insert lower mounting rod [8] into the hole of the sensor mounting block [5] closest to sensor housing [6].

Step 6. Position the rods so that mounting feet [2] are facing center of fan and the distance between the roll pin of each mounting foot [2] and the set screw on the sensor mounting block [5] is the measurement determined in Step 3.

Step 7. Tighten the set screws using hex wrench provided.

Step 8. Using the mounting feet [2] as a template, mark and drill the four pilot holes on the fan inlet bell throat [9] for the mounting screws [3] selected, so that the sensor probe is positioned as shown above (screws not provided).

Step 9. Confirm that the airflow directional arrow is pointing in the direction of airflow, and the cable is exiting downward.

Step 10. Position the probe on the fan inlet bell throat [9], and secure with the mounting screws [3] in the pre-drilled holes (screws not provided).

**!** Failure to properly install the probe can result in probe and/or fan damage.

Step 11. Using the tie wraps [7] provided secure cable to mounting rod (minimum of two tie wraps [7] per probe).

Step 12. If installing two probes in the fan inlet, repeat Steps 4 to 11, otherwise, continue to Step 13.

Step 13. For dual fan inlet or fan array applications, repeat steps above to install probes at the other fan inlet opening(s).

Step 14. Probe installation is complete! Figure “B” shows a completed two probe installation.